

# Flexible Coupling



## STYLE 75

Style 75 is available where moderate pressures are expected or weight considerations are a factor. Up to 50% lighter in weight than the Style 77, the Style 75 coupling is recommended for service up to 500 psi/3450 kPa depending on size. Housings are cast in two identical pieces in all sizes. Hot-dip galvanized and special coatings are available for all sizes.

The Victaulic standard flexible coupling offering for grade "EHP" or "T" gaskets is the Style 177 installation-ready flexible coupling. For all available sizes, the Style 177 is the standard flexible coupling Victaulic supplies in North America for piping systems using Grade "EHP" or "T" gaskets. Contact Victaulic for further details.

Performance data presented in this document is based on use with standard wall, carbon steel pipe. For use with stainless steel pipe, please reference document 17.09 for pressure ratings and end loads. When used on light wall stainless steel pipe, the Victaulic RX roll set must be used to roll groove the pipe. For further information regarding roll grooving stainless steel, refer to document 17.01.

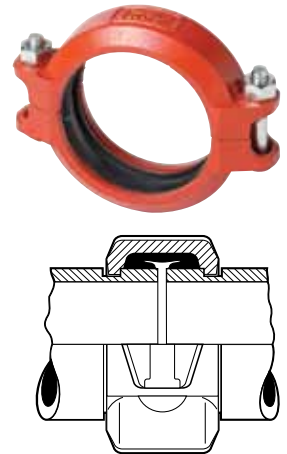

Exaggerated for clarity

### MATERIAL SPECIFICATIONS

**Housing:** Ductile iron conforming to ASTM A-536, grade 65-45-12. Ductile iron conforming to ASTM A-395, grade 65-45-15, is available upon special request.

**Housing Coating:** Orange enamel.

- **Optional:** Hot dipped galvanized and others.

**Gasket:** (specify choice\*)

- **Grade "E" EPDM**

EPDM (Green color code). Temperature range -30°F to +230°F/-34°C to +110°C. Recommended for hot water service within the specified temperature range plus a variety of dilute acids, oil-free air and many chemical services. UL classified in accordance with ANSI/NSF 61 for cold +86°F/+30°C and hot +180°F/+82°C potable water service. NOT RECOMMENDED FOR PETROLEUM SERVICES.

- **Grade "T" nitrile**

Nitrile (Orange color code). Temperature range -20°F to +180°F/-29°C to +82°C. Recommended for petroleum products, air with oil vapors, vegetable and mineral oils within the specified temperature range; except hot, dry air over +140°F/+60°C and water over +150°F/+66°C. NOT RECOMMENDED FOR HOT WATER SERVICES.

\* Services listed are General Service Recommendations only. It should be noted that there are services for which these gaskets are not recommended. Reference should always be made to the latest Victaulic Gasket Selection Guide for specific gasket service recommendations and for a listing of services which are not recommended.

NOTE: Additional gasket styles are available. Contact Victaulic for details.

**Bolts/Nuts:** Heat-treated plated carbon steel, trackhead meeting the physical and chemical requirements of ASTM A-449 and physical requirements of ASTM A-183.

|                  |                    |                            |
|------------------|--------------------|----------------------------|
| <b>JOB/OWNER</b> | <b>CONTRACTOR</b>  | <b>ENGINEER</b>            |
| System No. _____ | Submitted By _____ | Spec Sect _____ Para _____ |
| Location _____   | Date _____         | Approved _____             |
|                  |                    | Date _____                 |

# Flexible Coupling

## STYLE 75

### DIMENSIONS

| Size                   |                                   | Max. Work Pressure * | Max. End Load * | Allow. Pipe End Sep. † | Deflect. Fr. C <sub>L</sub> † |                   | Bolt/Nut@ No – Size | Dimensions – Inches/mm |              |            | Approx. Wgt. Each |
|------------------------|-----------------------------------|----------------------|-----------------|------------------------|-------------------------------|-------------------|---------------------|------------------------|--------------|------------|-------------------|
| Nominal Size Inches/mm | Actual Outside Diameter Inches/mm | psi/kPa              | Lbs./N          | Inches/mm              | Per Cplg. Deg.                | Pipe In./Ft. mm/m | Inches              | X                      | Y            | Z          | Lbs./kg           |
| 1<br>25                | 1.315<br>33.4                     | 500<br>3450          | 680<br>3025     | 0 – 0.06<br>0 – 1.6    | 2° – 43'                      | 0.57<br>48        | 2 – 3/8 x 2         | 2.38<br>61             | 4.27<br>108  | 1.77<br>45 | 1.3<br>0.6        |
| 1 1/4<br>32            | 1.660<br>42.2                     | 500<br>3450          | 1080<br>4805    | 0 – 0.06<br>0 – 1.6    | 2° – 10'                      | 0.45<br>38        | 2 – 3/8 x 2         | 2.68<br>68             | 4.61<br>117  | 1.77<br>45 | 1.4<br>0.6        |
| 1 1/2<br>40            | 1.900<br>48.3                     | 500<br>3450          | 1420<br>6320    | 0 – 0.06<br>0 – 1.6    | 1° – 56'                      | 0.40<br>33        | 2 – 3/8 x 2         | 2.91<br>74             | 4.82<br>122  | 1.77<br>45 | 1.5<br>0.6        |
| 2<br>50                | 2.375<br>60.3                     | 500<br>3450          | 2215<br>9860    | 0 – 0.06<br>0 – 1.6    | 1° – 31'                      | 0.32<br>26        | 2 – 3/8 x 2         | 3.43<br>87             | 5.22<br>133  | 1.88<br>48 | 1.7<br>0.8        |
| 2 1/2<br>65            | 2.875<br>73.0                     | 500<br>3450          | 3245<br>14440   | 0 – 0.06<br>0 – 1.6    | 1° – 15'                      | 0.26<br>22        | 2 – 3/8 x 2         | 3.88<br>98             | 5.68<br>144  | 1.88<br>48 | 1.9<br>0.9        |
| 76.1 mm                | 3.000<br>76.1                     | 500<br>3450          | 3535<br>15730   | 0 – 0.06<br>0 – 1.6    | 1° – 12'                      | 0.26<br>22        | 2 – 3/8 x 2         | 4.00<br>102            | 5.90<br>150  | 1.88<br>48 | 1.9<br>0.9        |
| 3<br>80                | 3.500<br>88.9                     | 500<br>3450          | 4800<br>21360   | 0 – 0.06<br>0 – 1.6    | 1° – 2'                       | 0.22<br>18        | 2 – 1/2 x 2 3/4     | 4.50<br>114            | 7.00<br>178  | 1.88<br>48 | 2.9<br>1.3        |
| 3 1/2<br>90            | 4.000<br>101.6                    | 500<br>3450          | 6300<br>28035   | 0 – 0.06<br>0 – 1.6    | 0° – 54'                      | 0.19<br>16        | 2 – 1/2 x 2 3/4     | 5.00<br>127            | 7.50<br>191  | 1.88<br>48 | 2.9<br>1.3        |
| 4<br>100               | 4.500<br>114.3                    | 500<br>3450          | 7950<br>35380   | 0 – 0.13<br>0 – 3.2    | 1° – 36'                      | 0.34<br>28        | 2 – 1/2 x 2 3/4     | 5.80<br>147            | 8.03<br>204  | 2.13<br>54 | 4.1<br>1.9        |
| 108.0mm                | 4.250<br>108.0                    | 450<br>3100          | 6380<br>28395   | 0 – 0.13<br>0 – 3.2    | 1° – 41'                      | 0.35<br>29        | 2 – 12 x 70.0       | 5.55<br>141            | 7.79<br>198  | 2.13<br>54 | 3.7<br>1.7        |
| 4 1/2<br>120           | 5.000<br>127.0                    | 450<br>3100          | 8820<br>39250   | 0 – 0.13<br>0 – 3.2    | 1° – 26'                      | 0.25<br>21        | 2 – 5/8 x 3 1/4     | 6.13<br>156            | 9.43<br>240  | 2.13<br>54 | 5.5<br>2.5        |
| 5<br>125               | 5.563<br>141.3                    | 450<br>3100          | 10935<br>48660  | 0 – 0.13<br>0 – 3.2    | 1° – 18'                      | 0.27<br>23        | 2 – 5/8 x 3 1/4     | 6.88<br>175            | 10.07<br>256 | 2.13<br>54 | 5.8<br>2.6        |
| 133.0mm                | 5.250<br>133.0                    | 450<br>3100          | 9735<br>43325   | 0 – 0.13<br>0 – 3.2    | 1° – 21'                      | 0.28<br>24        | 2 – 16 x 82.5       | 6.55<br>166            | 9.37<br>238  | 2.13<br>54 | 6.0<br>2.7        |
| 139.7mm                | 5.500<br>139.7                    | 450<br>3100          | 10665<br>47460  | 0 – 0.13<br>0 – 3.2    | 1° – 18'                      | 0.28<br>24        | 2 – 5/8 x 3 1/4     | 6.80<br>173            | 9.59<br>244  | 2.13<br>54 | 6.3<br>2.9        |
| 152.4mm                | 6.000<br>152.4                    | 450<br>3100          | 12735<br>56670  | 0 – 0.13<br>0 – 3.2    | 1° – 12'                      | 0.21<br>18        | 2 – 5/8 x 3 1/4     | 7.38<br>187            | 10.48<br>266 | 1.88<br>48 | 6.2<br>2.8        |
| 6<br>150               | 6.625<br>168.3                    | 450<br>3100          | 15525<br>69085  | 0 – 0.13<br>0 – 3.2    | 1° – 5'                       | 0.23<br>18        | 2 – 5/8 x 3 1/4     | 8.00<br>203            | 11.07<br>281 | 2.13<br>54 | 7.0<br>3.2        |
| 159.0mm                | 6.250<br>159.0                    | 450<br>3100          | 13800<br>61405  | 0 – 0.13<br>0 – 3.2    | 1° – 9'                       | 0.24<br>20        | 2 – 16 x 82.5       | 7.63<br>194            | 10.49<br>266 | 2.13<br>54 | 6.8<br>3.1        |
| 8<br>200               | 8.625<br>219.1                    | 450<br>3100          | 26280<br>116945 | 0 – 0.13<br>0 – 3.2    | 0° – 50'                      | 0.18<br>14        | 2 – 3/4 x 4 1/4     | 10.34<br>263           | 13.97<br>355 | 2.32<br>59 | 12.4<br>5.6       |

\* Working Pressure and End Load are total, from all internal and external loads, based on standard weight (ANSI) steel pipe, standard roll or cut grooved in accordance with Victaulic specifications. Contact Victaulic for performance on other pipe.

WARNING: FOR ONE TIME FIELD TEST ONLY, the Maximum Joint Working Pressure may be increased to 1 1/2 times the figures shown.

† Allowable Pipe End Separation and Deflection figures show the maximum nominal range of movement available at each joint for standard roll grooved pipe. Figures for standard cut grooved pipe may be doubled. These figures are maximums; for design and installation purposes these figures should be reduced by: 50% for 3/4 – 3 1/2"/20 – 90 mm; 25% for 4"/100 mm and larger.

@ Number of bolts required equals number of housing segments.

Metric thread size bolts are available (color coded gold) for all coupling sizes upon request. Contact Victaulic for details.

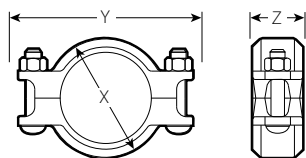

## Flexible Coupling

### STYLE 75

---

**WARRANTY**

Refer to the Warranty section of the current Price List or contact Victaulic for details.

---

**NOTE**

This product shall be manufactured by Victaulic or to Victaulic specifications. All products to be installed in accordance with current Victaulic installation/assembly instructions. Victaulic reserves the right to change product specifications, designs and standard equipment without notice and without incurring obligations.

---

**INSTALLATION**

Reference should always be made to the I-100 Victaulic Field Installation Handbook for the product you are installing. Handbooks are included with each shipment of Victaulic products for complete installation and assembly data, and are available in PDF format on our website at [www.victaulic.com](http://www.victaulic.com).

---

For complete contact information, visit [www.victaulic.com](http://www.victaulic.com)

06.05 1470 REV N UPDATED 01/2013

VICTAULIC IS A REGISTERED TRADEMARK OF VICTAULIC COMPANY. © 2013 VICTAULIC COMPANY. ALL RIGHTS RESERVED.

06.05

